

## GRANLUND COUNTERSINKS 90° Z3

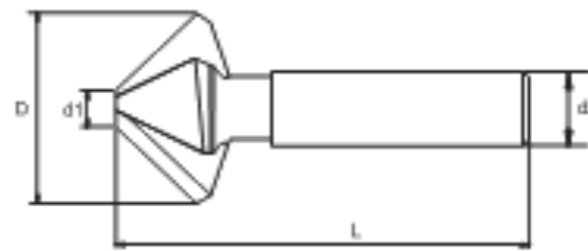

ITEM: A6108

Model 200T  
 Material HSS  
 Standard DIN 335C  
 Countersinking angle 90°  
 Surface treatment Bright  
 CUT Right-hand  
 Application 90° countersinking on all materials



< 500	< 650	< 1200	< 600	< 850	Duplex	< 240	< 300	< 10% Si	> 10% Si	Brass Copper	Ti6Al4V	HTA	< 45	< 60	< 65
●	●	○	●	○	○	●	●	●	○	○	○	○	○	○	○

### COUNTERSINK DIN 335 C

Tech. Code	D mm	L mm	d1 mm	d2 mm
A610810,4	10.4	47	2	6
A610812,4	12.4	48		
A610816,5	16.5	55	3	10

Tech. Code	D mm	L mm	d1 mm	d2 mm
A610820,5	20.5	58	4	10
A610825	25	61		
A610830	30	65		

## GRANLUND COUNTERSINKS 90° Z3 KIT



ITEM: A6109

Model 200T  
 Material HSS  
 Standard DIN 335C  
 Countersinking angle 90°  
 Surface treatment Bright  
 CUT Right

Tech. Code	Description
A6109SET	5 countersinks kit 200T Granlund Ø 10.4 - 16.5 - 20.5 - 25 - 30

## KERFOLG COUNTERSINKS 90° Z3



ITEM: A6110

Material HSS  
 Standard DIN 335C  
 Countersinking angle 90°  
 Surface treatment Bright  
 CUT Right-hand  
 Application 90° countersinking on all materials

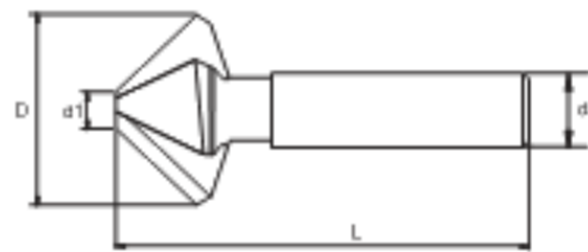

< 500	< 650	< 1200	< 600	< 850	Duplex	< 240	< 300	< 10% Si	> 10% Si	Brass Copper	Ti6Al4V	HTA	< 45	< 60	< 65
●	●	○	●	○	○	●	●	●	○	○	○	○	○	○	○

### COUNTERSINK DIN 335 C

Tech. Code	D mm	L mm	d1 mm	d2 mm
A61105	5.00	40	1.5	4
A61106	6.00	45		5
A61106,3	6.30			
A61108	8.00	50	2	6
A61108,3	8.30			
A611010	10.00		2.5	
A611010,4	10.40			
A611012,4	12.40	56	2.9	8

Tech. Code	D mm	L mm	d1 mm	d2 mm
A611015	15.00	60	3.2	10
A611016,5	16.50			
A611020,5	20.50			
A611025	25.00	67	3.8	12
A611028	28.00			
A611030	30.00	71	4.2	
A611031	31.00			

## KERFOLG COUNTERSINKS 90° Z3 KIT



ITEM: A6125

Material HSS  
 Standard DIN 335C  
 Countersinking angle 90°  
 Surface treatment Bright - TIN  
 CUT Right-hand  
 Application 90° countersinking on all materials

Tech. Code	Description
A6125SETA6110	Set of 5 countersink A6110 90° Ø 8 - 12.4 - 16.5 - 20.5 - 25
A6125SETA6115	Set of 5 countersink A6115 90° TIN Ø 8 - 12.4 - 16.5 - 20.5 - 25