

Heavy Duty Inline Stainless Steel Manifold

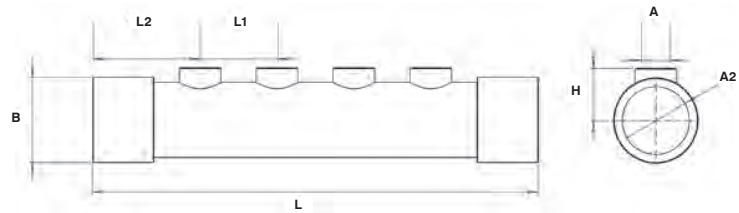

Part No.	Ports	A	A2	L	L1	L2	B	H
SSIM6-4-1/2	4	G 1/2"	G 1.1/2"	290	50	69,5	55	34
SSIM6-8-1/2	8	G 1/2"	G 1.1/2"	490	50	69,5	55	34
SSIM6-12-1/2	12	G 1/2"	G 1.1/2"	690	50	69,5	55	34

Welded pipe construction
Stainless Steel AISI 304
Perfect for aggressive water and oil

Max. pressure 10 bar.
Max temp. 200°C.

Brackets for heavy duty Stainless Steel Manifolds



Part No.	Size	
SS-6-Bracket	1.1/2"	1

Electro plated steel bracket for installation of a single manifold
2 Brackets needed for correct installation

Blanking Plugs

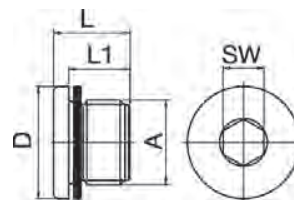

Part No.	A	D	L	L1	SW	
DR1-1/2*	G 1-1/2"	55	22,5	16	24	1

Material: Plated Brass
With O-ring