

SPRUE GRIPPER - SERIES GS14 (THREADED/SHORT)



GS14A-14



GS14B-14



GS14C-14



GS14D-14



GS14E-14

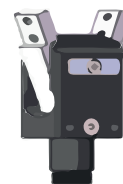

GS14F-14



GS14A-14-CN/CP



GS14B-14-CN/CP



GS14C-14-CN/CP



GS14D-14-CN/CP



GS14E-14-CN/CP

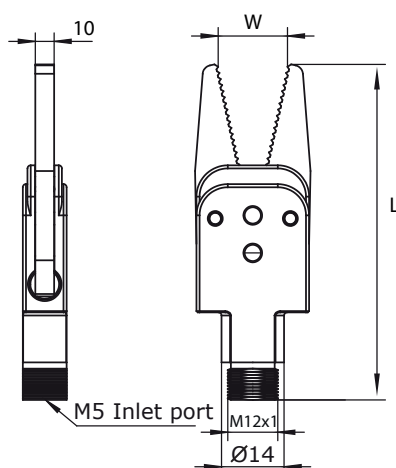

DIAMOND PATTERN



SERRATED



CURVED



SAW TOOTH



SILICONE PAD

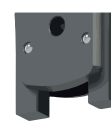

CUSTOM

INORMA	JAW TYPE	SENSOR	L	W	OPEN/CLOSE (N/cm)	WEIGHT (g)
NPC.GS14A14	DIAMOND PATTERN	-	89.5	23	7/130	68
NPC.GS14A14CP	DIAMOND PATTERN	PNP	89.5	22	7/130	80
NPC.GS14A14CN	DIAMOND PATTERN	NPN	89.5	22	7/130	80
NPC.GS14B14	SERRATED	-	89.5	23	7/130	68
NPC.GS14B14CP	SERRATED / DIAMOND PATTERN	PNP	89.5	22	7/130	80
NPC.GS14B14CN	SERRATED / DIAMOND PATTERN	NPN	89.5	22	7/130	80
NPC.GS14C14	SILICONE PAD	-	89.5	23	7/130	68
NPC.GS14C14CP	SILICONE PAD	PNP	89.5	22	7/130	80
NPC.GS14C14CN	SILICONE PAD	NPN	89.5	22	7/130	80
NPC.GS14D14	SAW TOOTH	-	89.5	23	7/130	68
NPC.GS14D14CP	SAW TOOTH	PNP	89.5	22	7/130	80
NPC.GS14D14CN	SAW TOOTH	NPN	89.5	22	7/130	80
NPC.GS14E14	CURVED	-	89.5	23	7/130	68
NPC.GS14E14CP	CURVED	PNP	89.5	22	7/130	80
NPC.GS14E14CN	CURVED	NPN	89.5	22	7/130	80
NPC.GS14F14	CUSTOM	-	76	27	7/130	68

2.5 - 8bar