

MANIFOLDS

Inline Stainless Steel Manifold

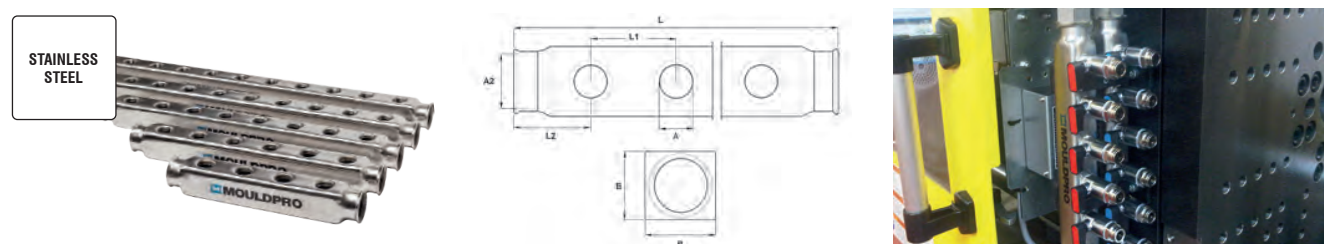

Part No.	Ports	A	A2	L	L1	L2	B
SSIM4-4-1/2	4	G 1/2"	G 1"	240	50	45	40
SSIM4-6-1/2	6	G 1/2"	G 1"	340	50	45	40
SSIM4-8-1/2	8	G 1/2"	G 1"	440	50	45	40
SSIM4-10-1/2	10	G 1/2"	G 1"	540	50	45	40
SSIM4-12-1/2	12	G 1/2"	G 1"	640	50	45	40
SSIM5-4-1/2	4	G 1/2"	G 1-1/4"	240	50	45	50
SSIM5-6-1/2	6	G 1/2"	G 1-1/4"	340	50	45	50
SSIM5-8-1/2	8	G 1/2"	G 1-1/4"	440	50	45	50
SSIM5-10-1/2	10	G 1/2"	G 1-1/4"	540	50	45	50
SSIM5-12-1/2	12	G 1/2"	G 1-1/4"	640	50	45	50

Stainless steel AISI 304.
Perfect for aggressive water and oil.

Max. pressure 10 bar.
Max temp. 200°C.

Brackets for Stainless Steel Manifolds



Part No.	Type	
SS-Bracket	1"	1
SS-5-Bracket	1-1/4"	1

Electro plated steel bracket for installation of a single manifold.
2 Brackets needed for correct installation.

Equal Connector for Stainless Manifolds

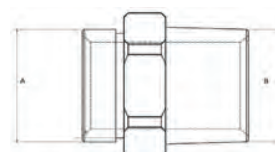

Part No.	A	B	
ECM1	G 1"	R 1"	1
ECM1-1/4	G 1-1/4"	R 1-1/4"	1

Material: Brass Nickel Plated.
Max temp.: 130°C.

O-Ring: 1" = EPDM.
1-1/4" = SILICONE.

Blanking Plug



Part No.	Thread	Seal
SSEC1	G 1"	FKM max. temp. 200°C
SSEC1-1/4	G 1-1/4"	FKM max. temp. 200°C

Material: Nickel plated brass

Heavy Duty Inline Stainless Steel Manifold

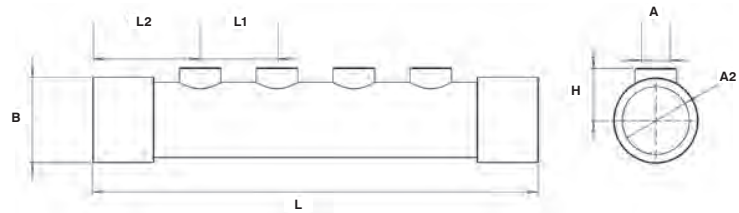

Part No.	Ports	A	A2	L	L1	L2	B	H
SSIM6-4-1/2	4	G 1/2"	G 1.1/2"	290	50	69,5	55	34
SSIM6-8-1/2	8	G 1/2"	G 1.1/2"	490	50	69,5	55	34
SSIM6-12-1/2	12	G 1/2"	G 1.1/2"	690	50	69,5	55	34

Welded pipe construction
Stainless Steel AISI 304
Perfect for aggressive water and oil

Max. pressure 10 bar.
Max temp. 200°C.

Brackets for heavy duty Stainless Steel Manifolds



Part No.	Size	
SS-6-Bracket	1.1/2"	1

Electro plated steel bracket for installation of a single manifold
2 Brackets needed for correct installation

Blanking Plugs

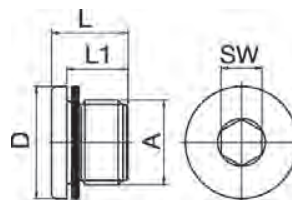

Part No.	A	D	L	L1	SW	
DR1-1/2*	G 1-1/2"	55	22,5	16	24	1

Material: Plated Brass
With O-ring